

© Crown copyright and Landmark Information Group Limited 2025. All Rights Reserved.

# Envirocheck®

LANDMARK INFORMATION GROUP®

## Ordnance Survey Plan

Published 1959

Source map scale - 1:10,000

The historical maps shown were reproduced from maps predominantly held at the scale adopted for England, Wales and Scotland in the 1840's. In 1854 the 1:2,500 scale was adopted for mapping urban areas; these maps were used to update the 1:10,560 maps. The published date given therefore is often some years later than the surveyed date. Before 1938, all OS maps were based on the Cassini Projection, with independent surveys of a single county or group of counties, giving rise to significant inaccuracies in outlying areas. In the late 1940's, a Provisional Edition was produced, which updated the 1:10,560 mapping from a number of sources. The maps appear unfinished - with all military camps and other strategic sites removed. These maps were initially overprinted with the National Grid. In 1970, the first 1:10,000 maps were produced using the Transverse Mercator Projection. The revision process continued until recently, with new editions appearing every 10 years or so for urban areas.

## Map Name(s) and Date(s)

NJ63NE	NJ73NW
1959	1959
1:10,560	1:10,560
NJ63SE	NJ73SW
1959	1959
1:10,560	1:10,560

## Historical Map - Slice A

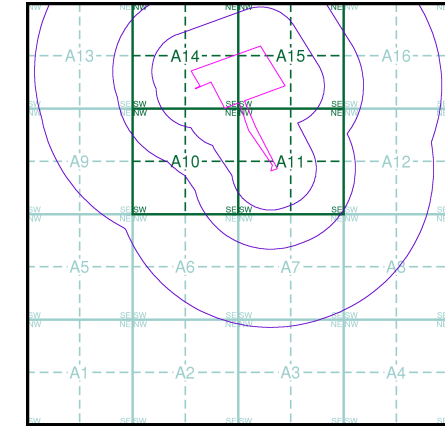

## Order Details

Order Number: 375640468\_1\_1  
Customer Ref: E12482  
National Grid Reference: 369550, 835400  
Slice: A  
Site Area (Ha): 14.46  
Search Buffer (m): 1000

## Site Details

Site at, Rothienorman, Aberdeenshire

**Landmark**  
INFORMATION GROUP  
Tel: 0844 844 9952  
Fax: 0844 844 9951  
Web: www.envirocheck.co.uk



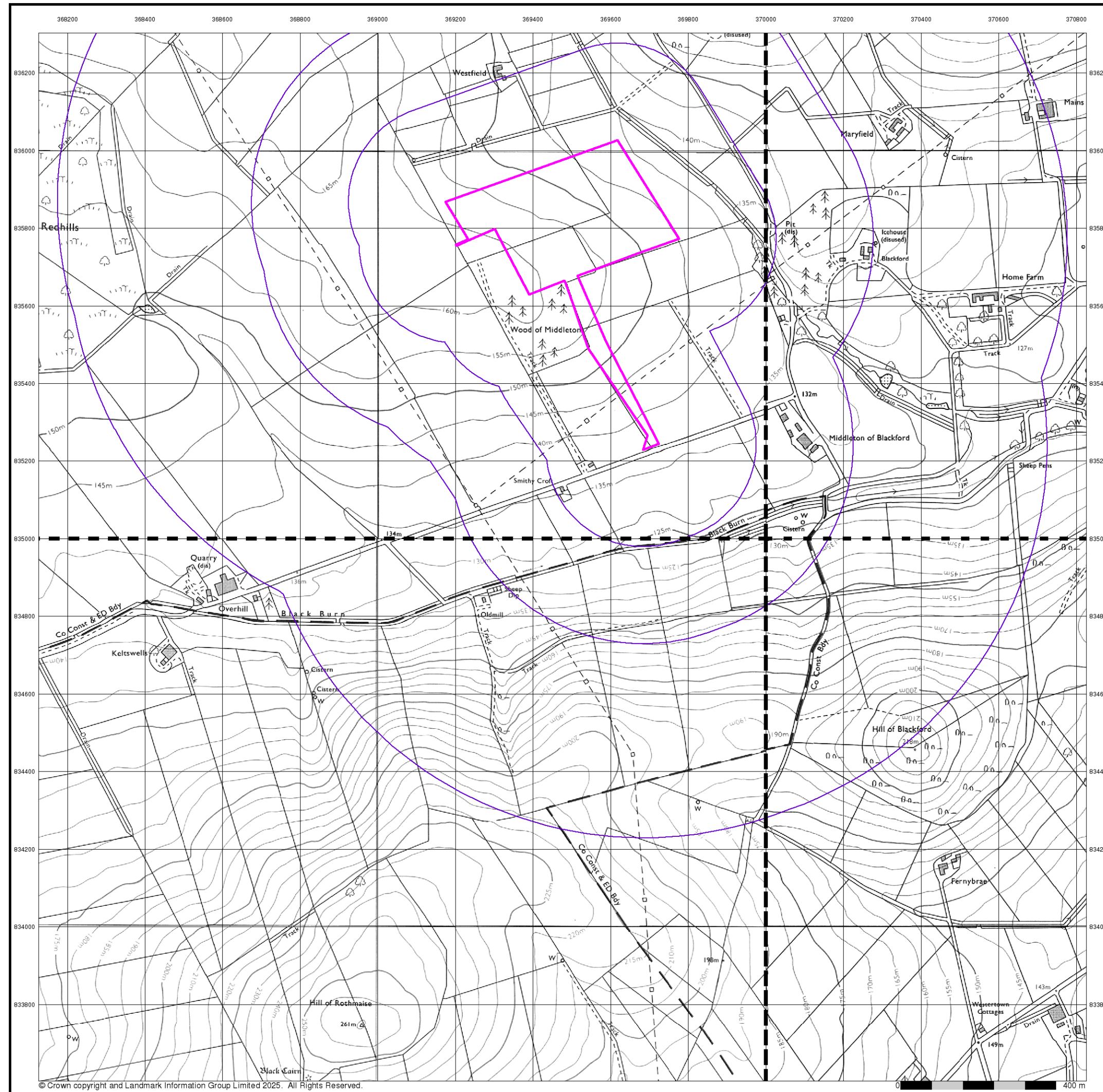

© Crown copyright and Landmark Information Group Limited 2025. All Rights Reserved.

## Ordnance Survey Plan

**Published 1983 - 1984**

**Source map scale - 1:10,000**

The historical maps shown were reproduced from maps predominantly held at the scale adopted for England, Wales and Scotland in the 1840's. In 1854 the 1:2,500 scale was adopted for mapping urban areas; these maps were used to update the 1:10,560 maps. The published date given therefore is often some years later than the surveyed date. Before 1938, all OS maps were based on the Cassini Projection, with independent surveys of a single county or group of counties, giving rise to significant inaccuracies in outlying areas. In the late 1940's, a Provisional Edition was produced, which updated the 1:10,560 mapping from a number of sources. The maps appear unfinished - with all military camps and other strategic sites removed. These maps were initially overprinted with the National Grid. In 1970, the first 1:10,000 maps were produced using the Transverse Mercator Projection. The revision process continued until recently, with new editions appearing every 10 years or so for urban areas.

### Map Name(s) and Date(s)

NJ63NE	NJ73NW
1983	1984
1:10,000	1:10,000
+	
NJ63SE	NJ73SW
1983	1984
1:10,000	1:10,000

### Historical Map - Slice A

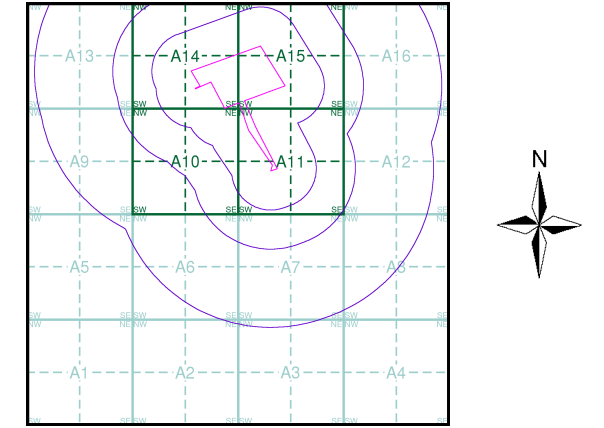

**Order Details**

Order Number: 375640468\_1\_1  
Customer Ref: E12482  
National Grid Reference: 369550, 835400  
Slice: A  
Site Area (Ha): 14.46  
Search Buffer (m): 1000

**Site Details**

Site at, Rothienorman, Aberdeenshire



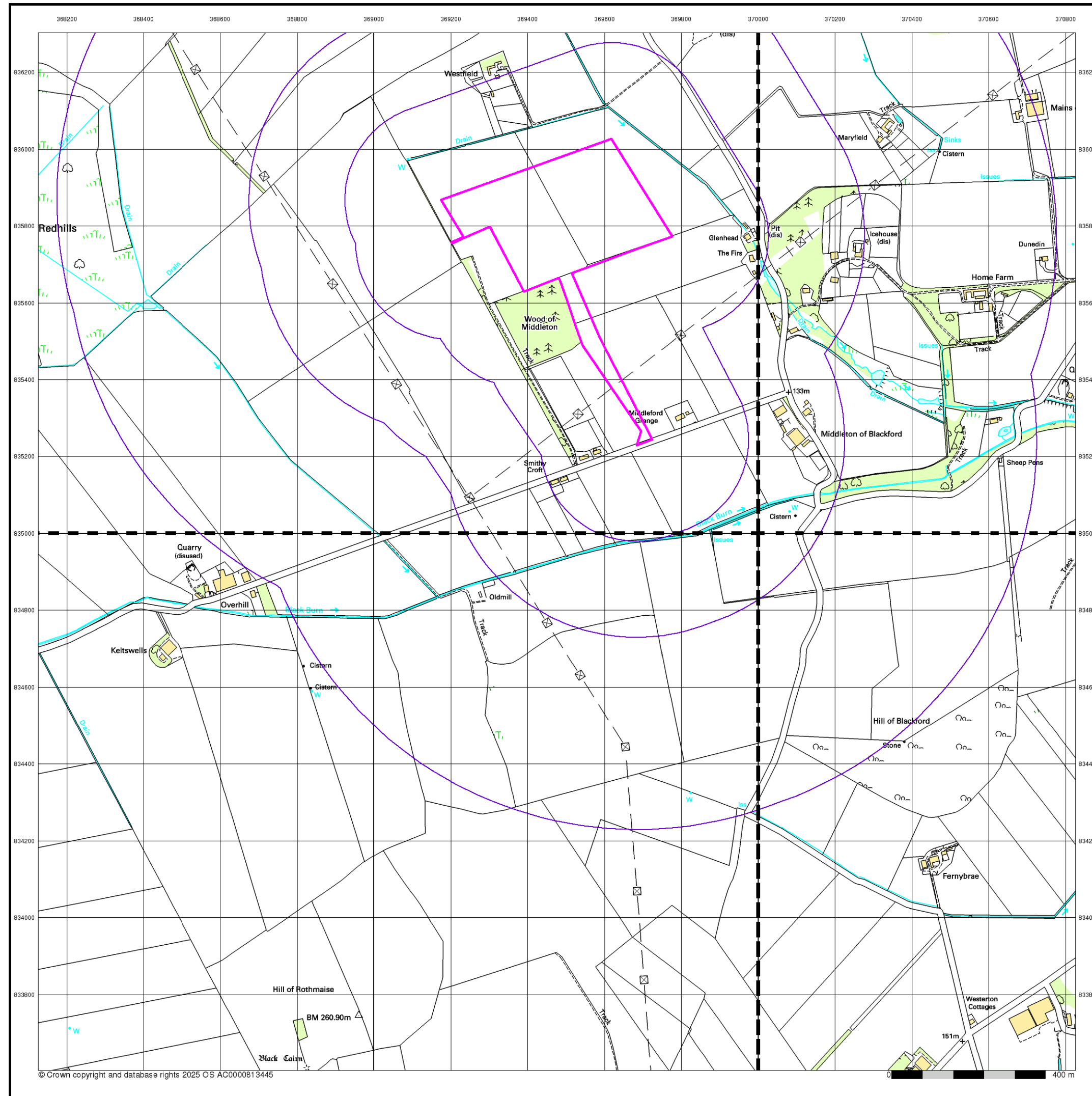

10k Raster Mapping

Published 2000

Source map scale - 1:10,000

The historical maps shown were produced from the Ordnance Survey's 1:10,000 colour raster mapping. These maps are derived from Landplan which replaced the old 1:10,000 maps originally published in 1970. The data is highly detailed showing buildings, fences and field boundaries as well as all roads, tracks and paths. Road names are also included together with the relevant road number and classification. Boundary information depiction includes county, unitary authority, district, civil parish and constituency.

Map Name(s) and Date(s)

NJ63NE	NJ73NW
2000	2000
1:10,000	1:10,000
NJ63SE	NJ73SW
2000	2000
1:10,000	1:10,000

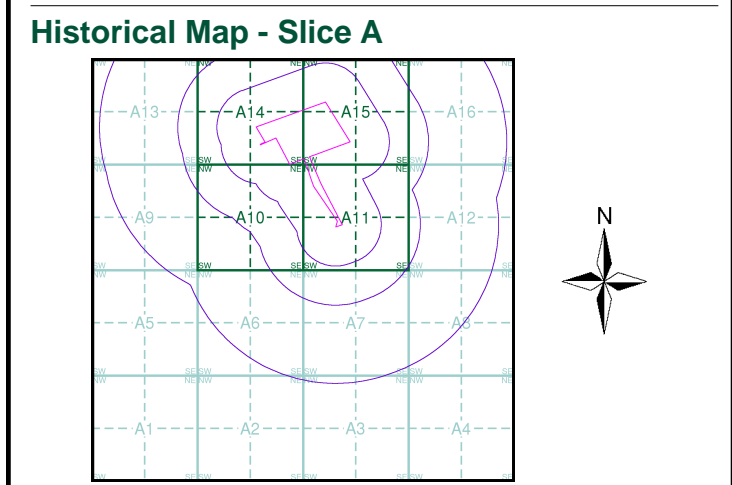

Order Details

Order Number: 375640468\_1\_1

Customer Ref: E12482

National Grid Reference: 369550, 835400

Slice: A

Site Area (Ha): 14.46

Search Buffer (m): 1000

Site Details

Site at, Rothienorman, Aberdeenshire



10k Raster Mapping

Published 2006

Source map scale - 1:10,000

The historical maps shown were produced from the Ordnance Survey's 1:10,000 colour raster mapping. These maps are derived from Landplan which replaced the old 1:10,000 maps originally published in 1970. The data is highly detailed showing buildings, fences and field boundaries as well as all roads, tracks and paths. Road names are also included together with the relevant road number and classification. Boundary information depiction includes county, unitary authority, district, civil parish and constituency.

Map Name(s) and Date(s)

NJ63NE	NJ73NW
2006	2006
1:10,000	1:10,000
NJ63SE	NJ73SW
2006	2006
1:10,000	1:10,000

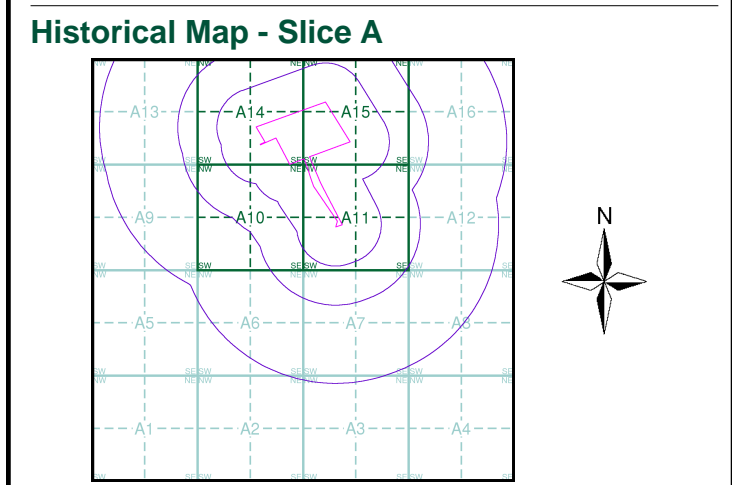

Order Details

Order Number: 375640468\_1\_1

Customer Ref: E12482

National Grid Reference: 369550, 835400

Slice: A

Site Area (Ha): 14.46

Search Buffer (m): 1000

Site Details

Site at, Rothienorman, Aberdeenshire



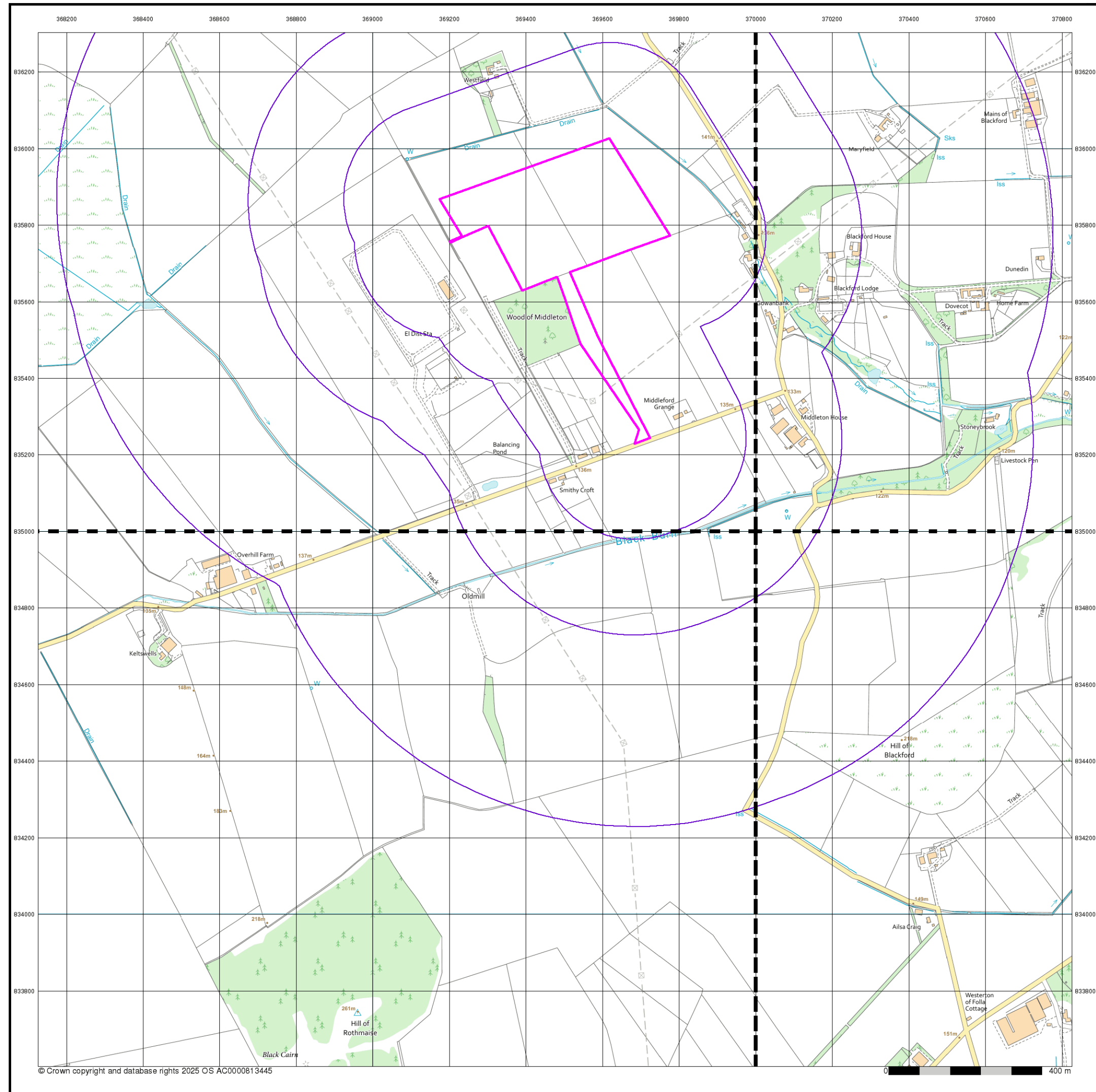

# Envirocheck<sup>®</sup>

LANDMARK INFORMATION GROUP<sup>®</sup>

## VectorMap Local

**Published 2024**

**Source map scale - 1:10,000**

VectorMap Local (Raster) is Ordnance Survey's highest detailed 'backdrop' mapping product. These maps are produced from OS's VectorMap Local, a simple vector dataset at a nominal scale of 1:10,000, covering the whole of Great Britain, that has been designed for creating graphical mapping. OS VectorMap Local is derived from large-scale information surveyed at 1:1250 scale (covering major towns and cities), 1:2500 scale (smaller towns, villages and developed rural areas), and 1:10 000 scale (mountain, moorland and river estuary areas).

### Map Name(s) and Date(s)

NJ63NE	NJ73NW
2024	2024
Variable	Variable



NJ63SE	NJ73SW
2024	2024
Variable	Variable

### Historical Map - Slice A

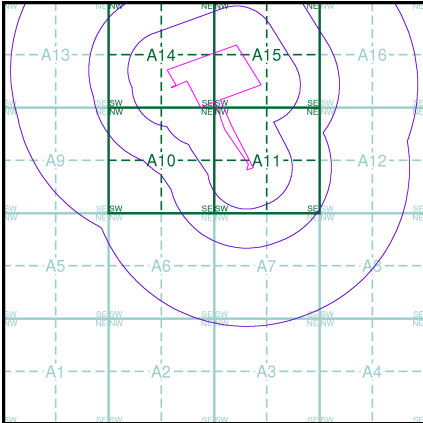

### Order Details

Order Number:	375640468_1_1
Customer Ref:	E12482
National Grid Reference:	369550, 835400
Slice:	A
Site Area (Ha):	14.46
Search Buffer (m):	1000

### Site Details

Site at, Rothienorman, Aberdeenshire

## Landmark<sup>®</sup>

INFORMATION GROUP

Tel: 0844 844 9952  
Fax: 0844 844 9951  
Web: [www.envirocheck.co.uk](http://www.envirocheck.co.uk)

© Crown copyright and database rights 2025 OS AC0000813445

A Landmark Information Group Service v50.0 29-Apr-2025 Page 8 of 8